



# KITCHEN STUDIO<sup>™</sup>

Crafting kitchens since 2006

Client Name: Mr & Mrs Mehta  
Design by : Parisha  
Date: 07.05.2025



---

We are not  
just  
designing  
kitchens,  
we are  
designing  
human  
Experiences.



KITCHEN STUDIO is characterised by enduring aesthetics, functionality, craftsmanship and world class quality. We know the possibilities are endless & hence we offer the most innovative and customised solutions for all your kitchen needs.







Our philosophy

"RECOGNIZING THE NEED  
IS THE PRIMARY  
CONDITION FOR DESIGN."

CHARLES EAMES







# KITCHEN ELEVATIONAL DETAILS



KITCHENSTUDIO.IN

# KITCHEN LAYOUT

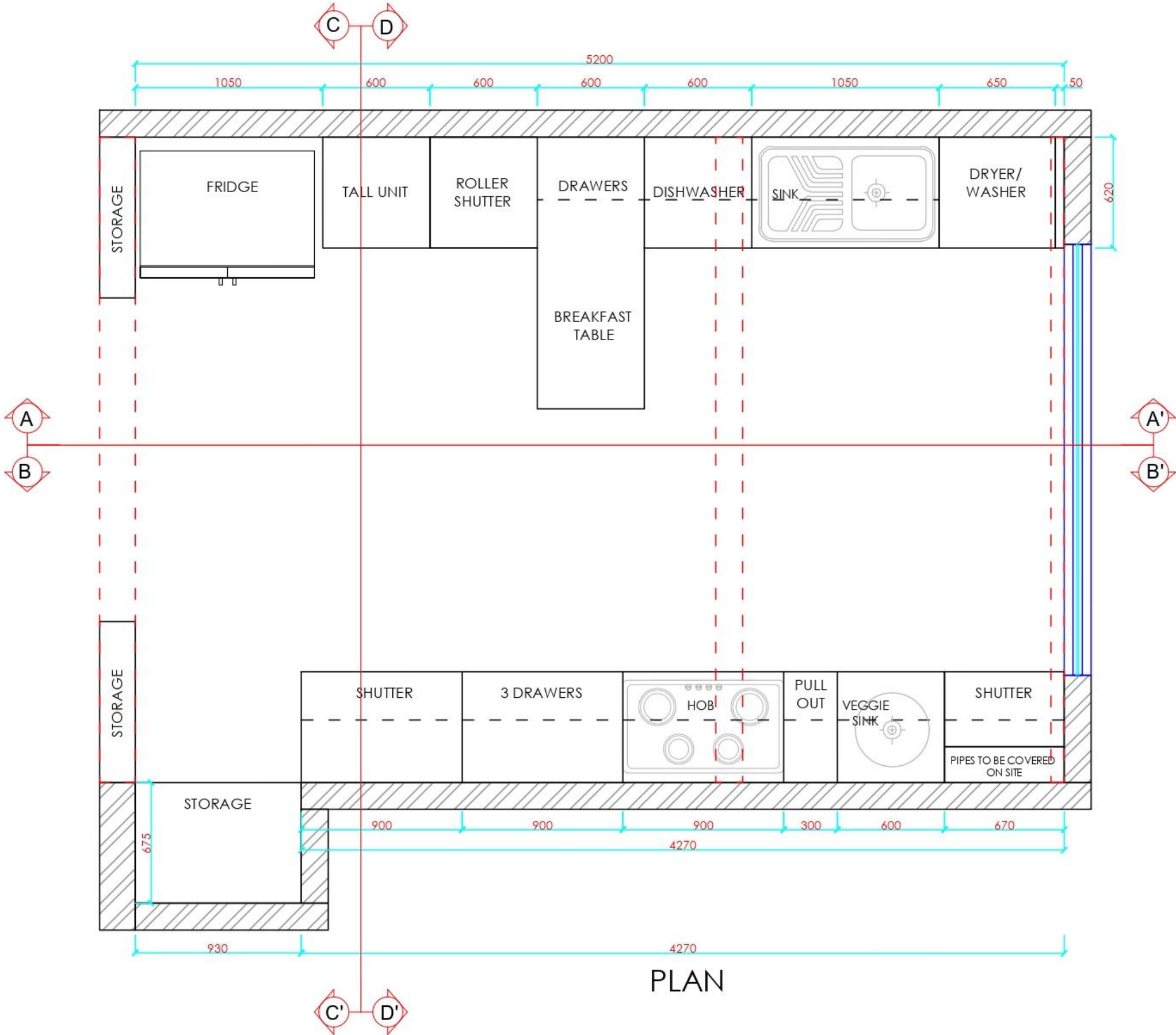



# ELEVATION A

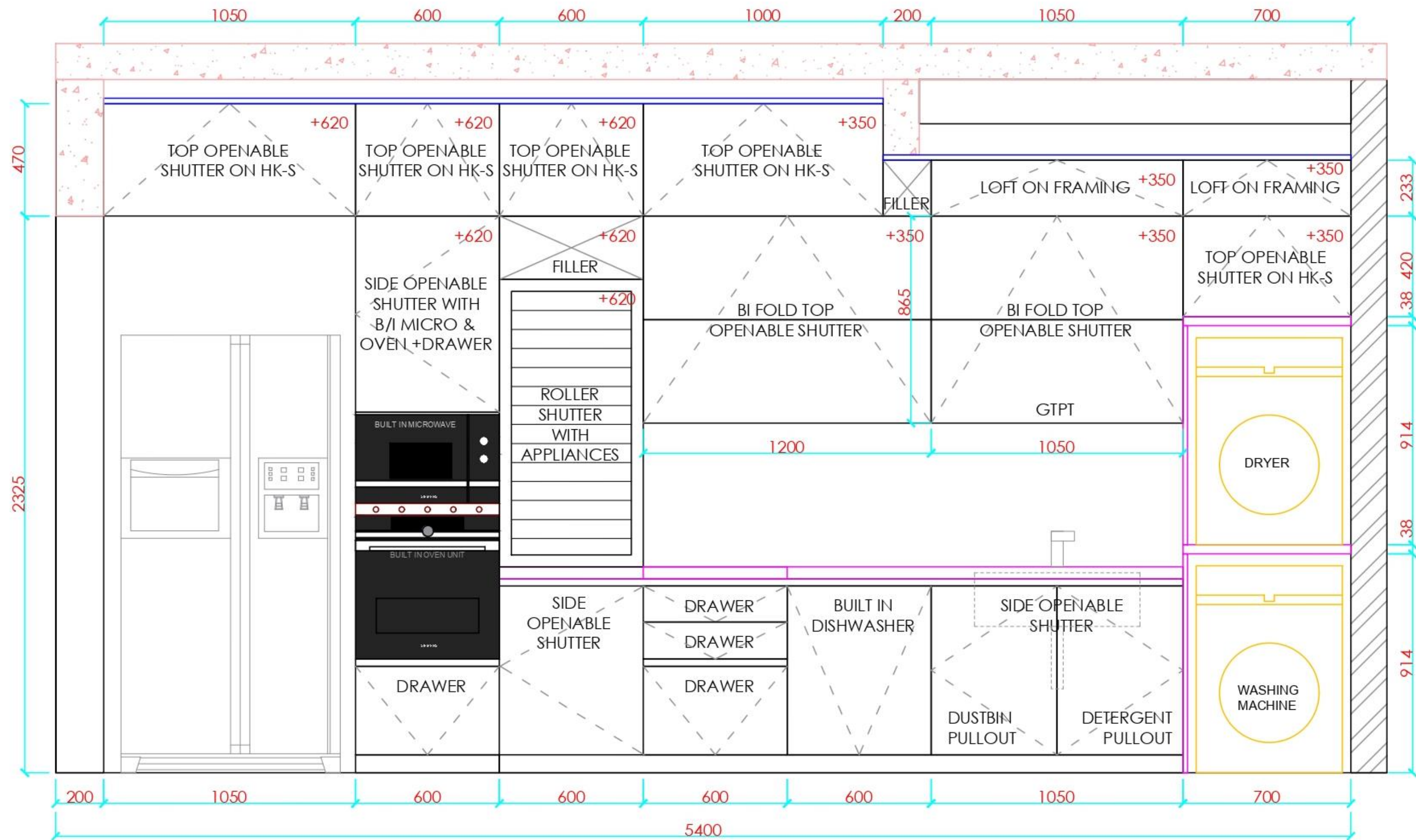

# ELEVATION B

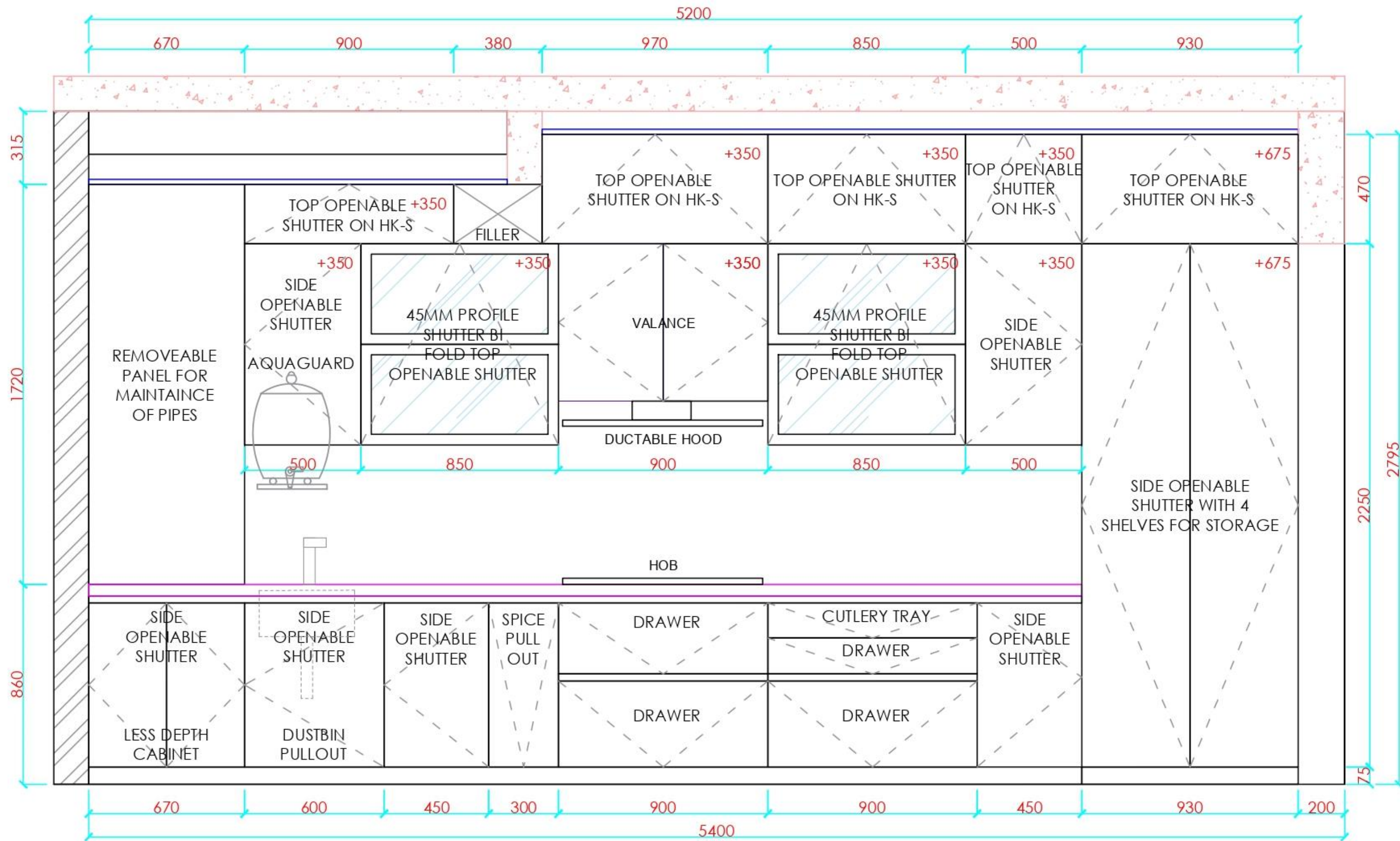



# ELEVATION C

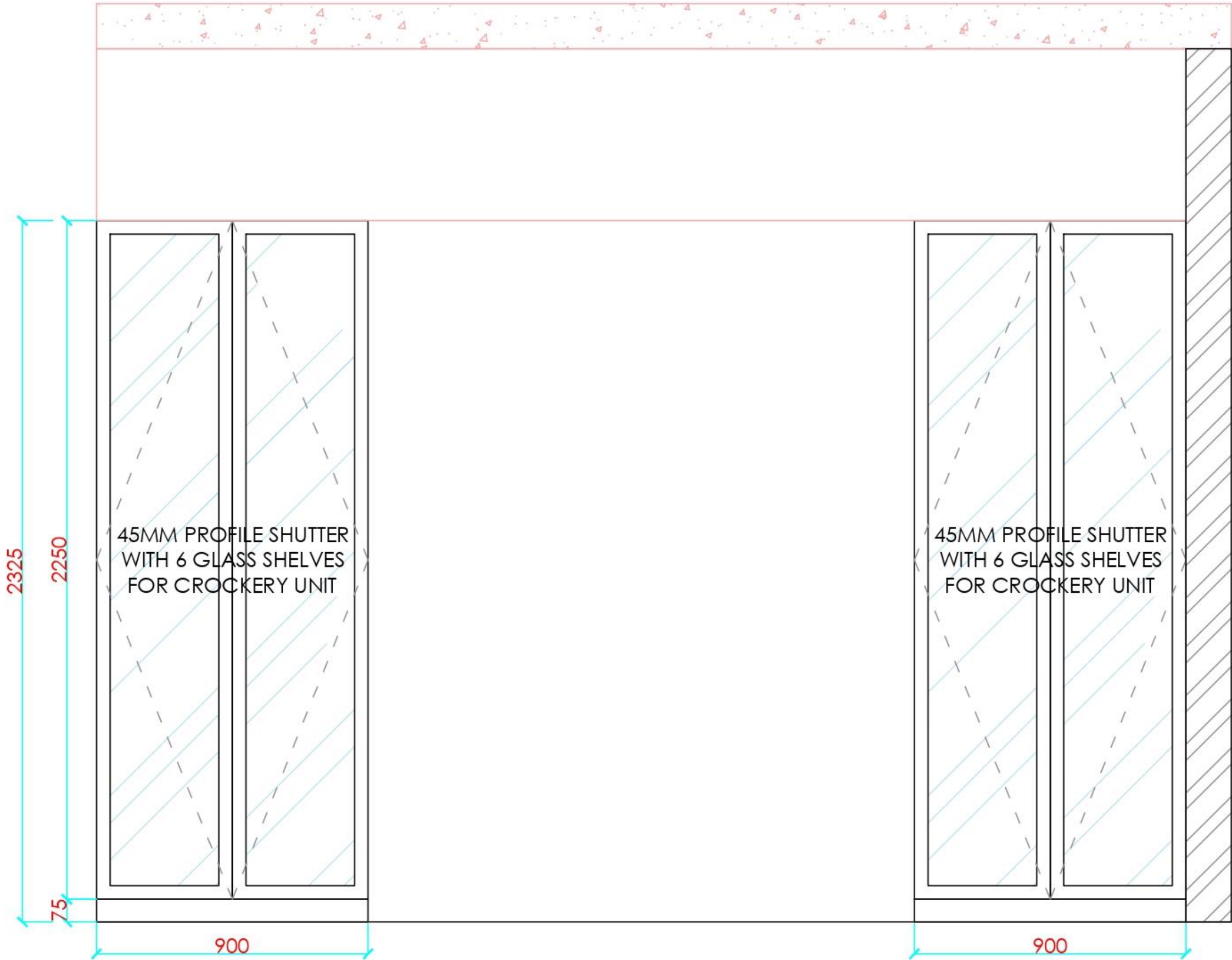



# ELEVATION D

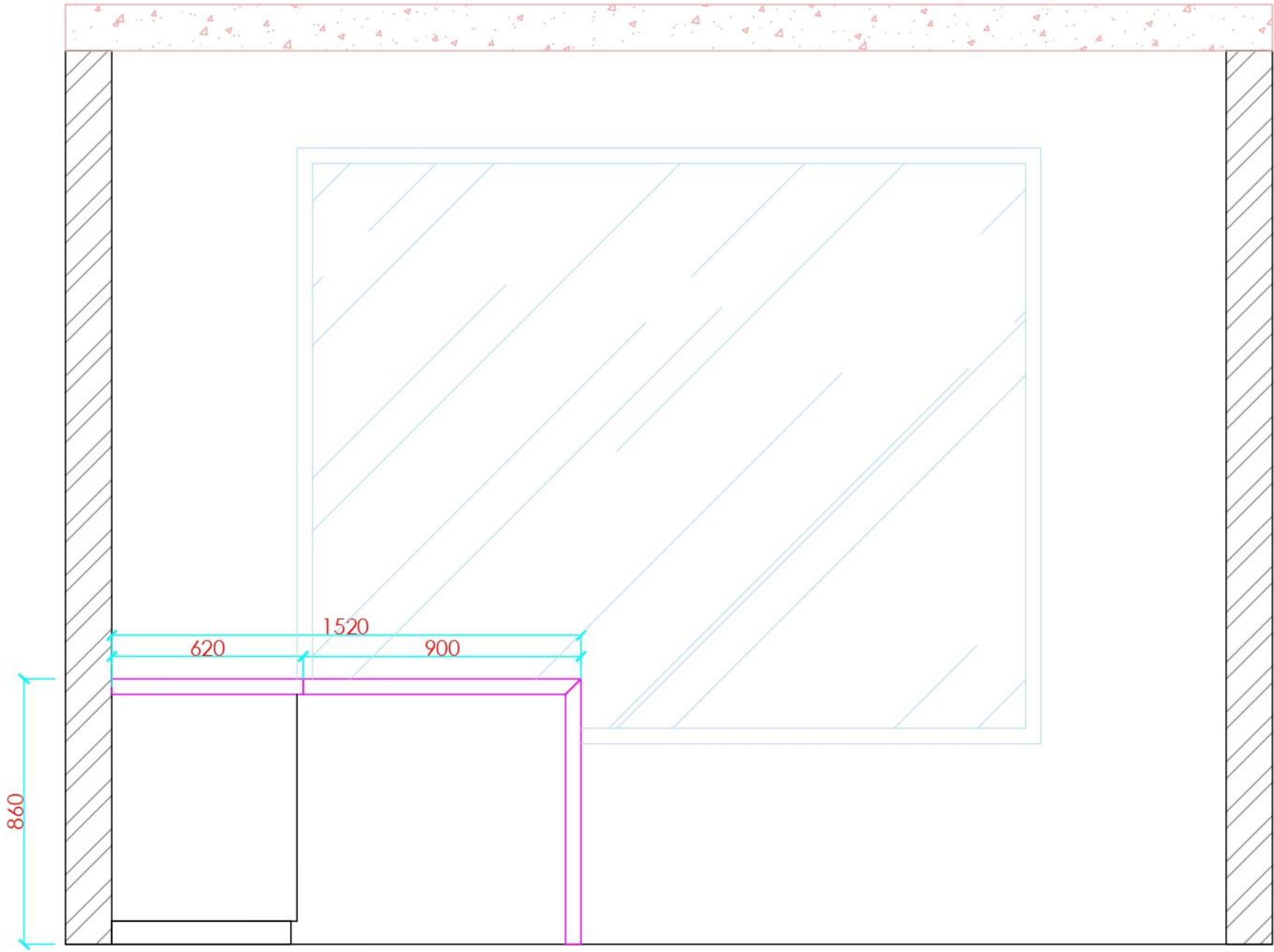

# INTERNAL DETAILS ELEVATION A



**TALL UNIT**

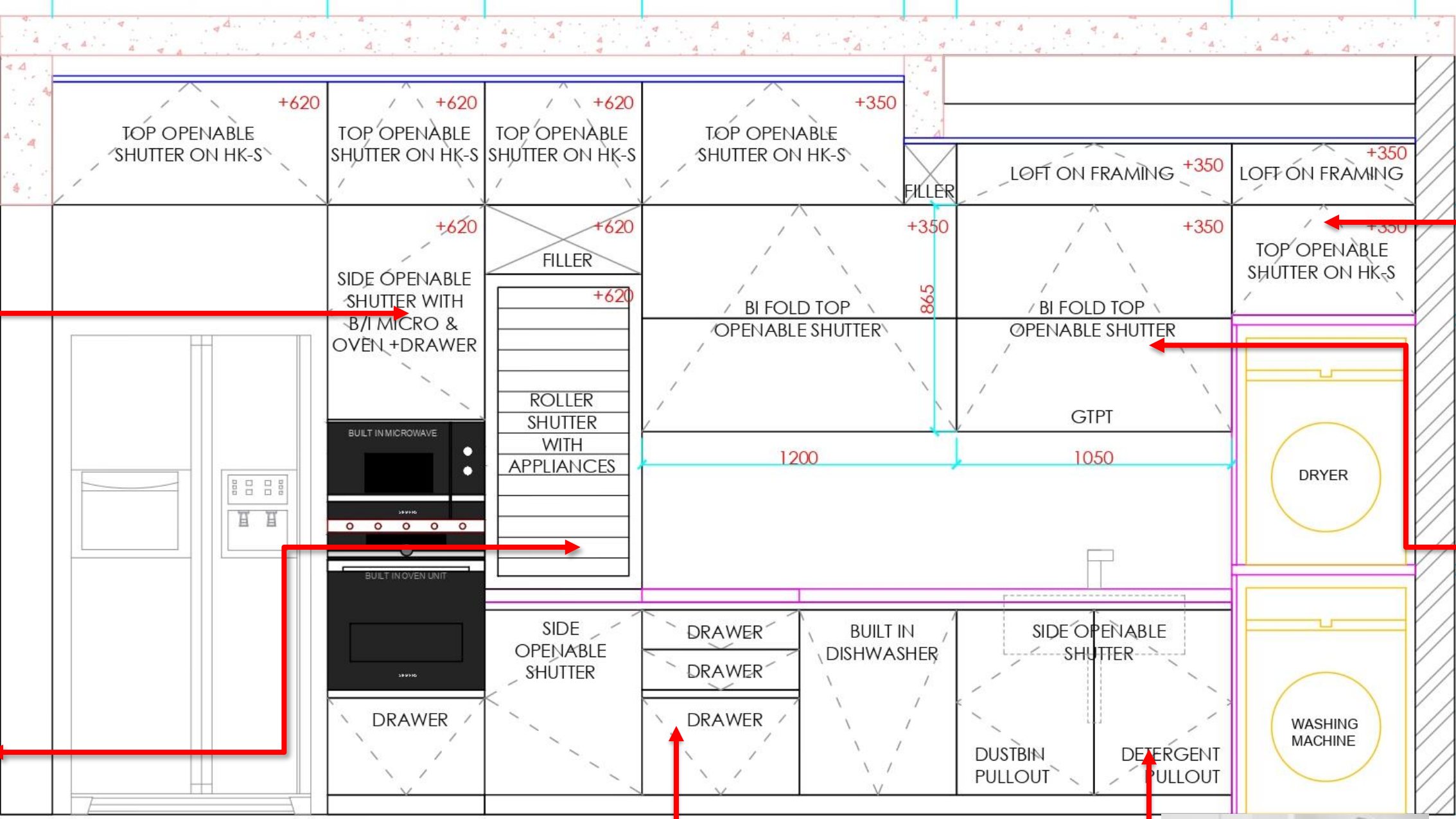



Diagram labels and dimensions:

- Dimensions: 470, 2325, 233, 38, 420, 914, 914, 1200, 1050, 865.
- Labels: TOP OPENABLE SHUTTER ON HK-S, SIDE OPENABLE SHUTTER WITH B/I MICRO & OVEN + DRAWER, BUILT IN MICROWAVE, BUILT IN OVEN UNIT, DRAWER, ROLLER SHUTTER WITH APPLIANCES, BI FOLD TOP OPENABLE SHUTTER, GTPT, DRYER, WASHING MACHINE, DUSTBIN PULLOUT, DETERGENT PULLOUT, BUILT IN DISHWASHER, SIDE OPENABLE SHUTTER, FILLER, LOFT ON FRAMING, FILLER.



**HK-S TOP OPENABLE**



**BI FOLD TOP OPENABLE**



**RIOLLER SHUTTER**



**ANTARO BLUM DRAWER**



**DETERGENT PULLOUT**



**WET & DRY DUSTBIN**







# DETAILS INCORPORATED AS PER EXISTING KITCHEN ELEVATION A



PANS & UTENSILS STORAGE



SMALL APPLIANCES STORAGE

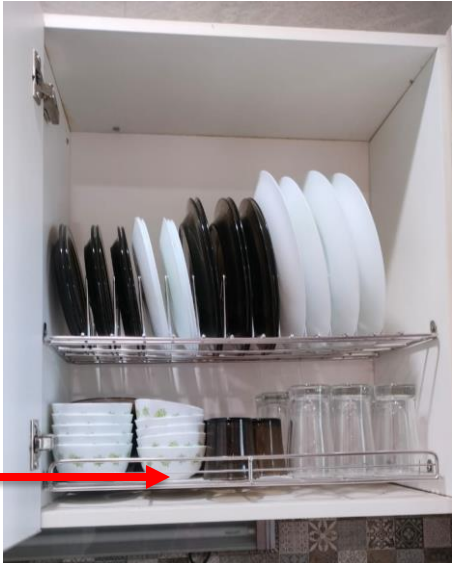
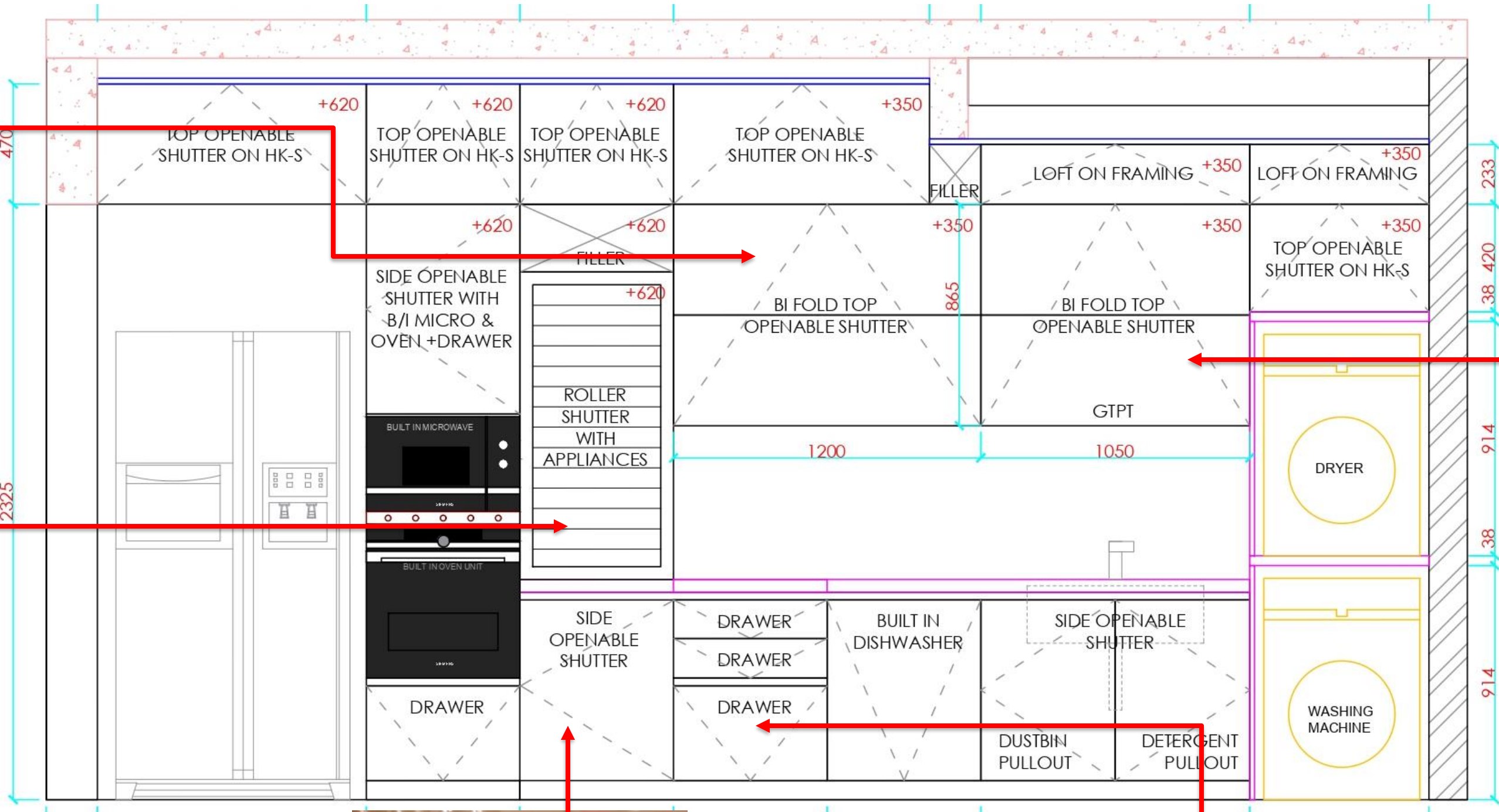

STORAGE FOR PLATES



DRAWERS FOR SNACKS & CAN INCORPORATE ADDITIONAL STORAGE



JARS OF SPICES



# DETAILS INCORPORATED AS PER EXISTING KITCHEN ELEVATION B



AQUAGUARD & MATKA  
ABOVE SINK



STORAGE FOR CROCKERY

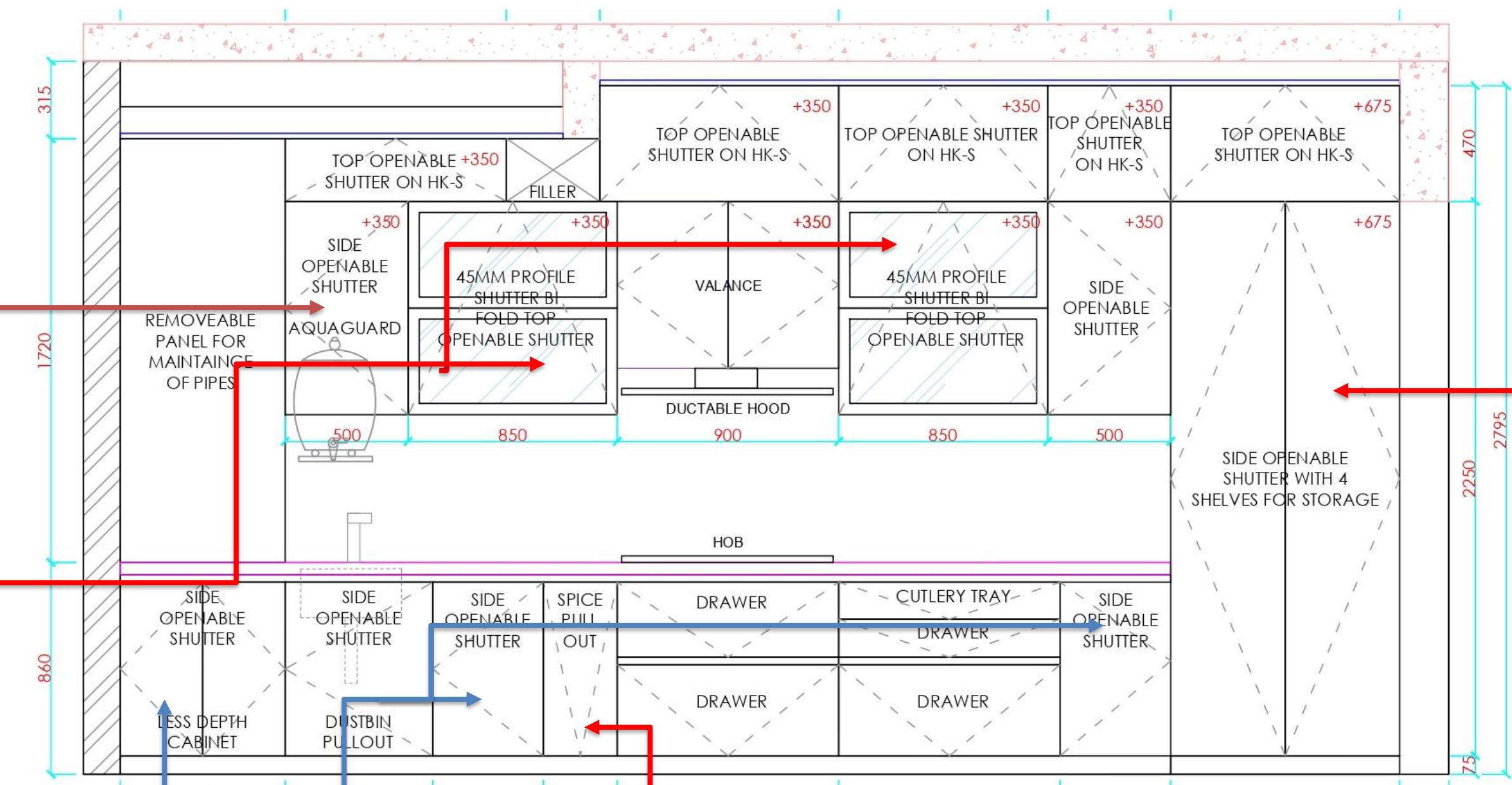
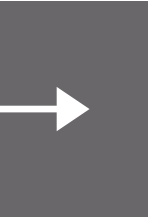

BIG CANS FOR STORING GRAINS

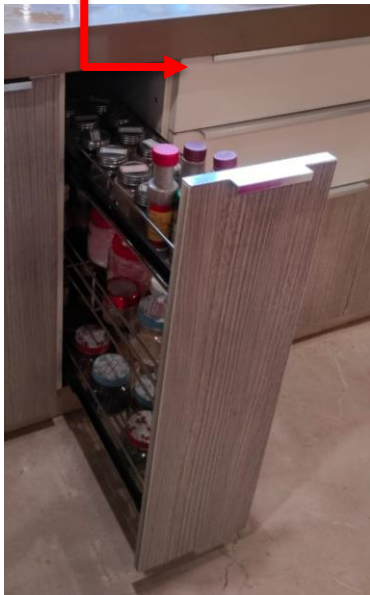

SPICE PULL OUT



STORAGE



# DETAILS INCORPORATED AS PER EXISTING KITCHEN ELEVATION C



STORAGE FOR CROCKERY

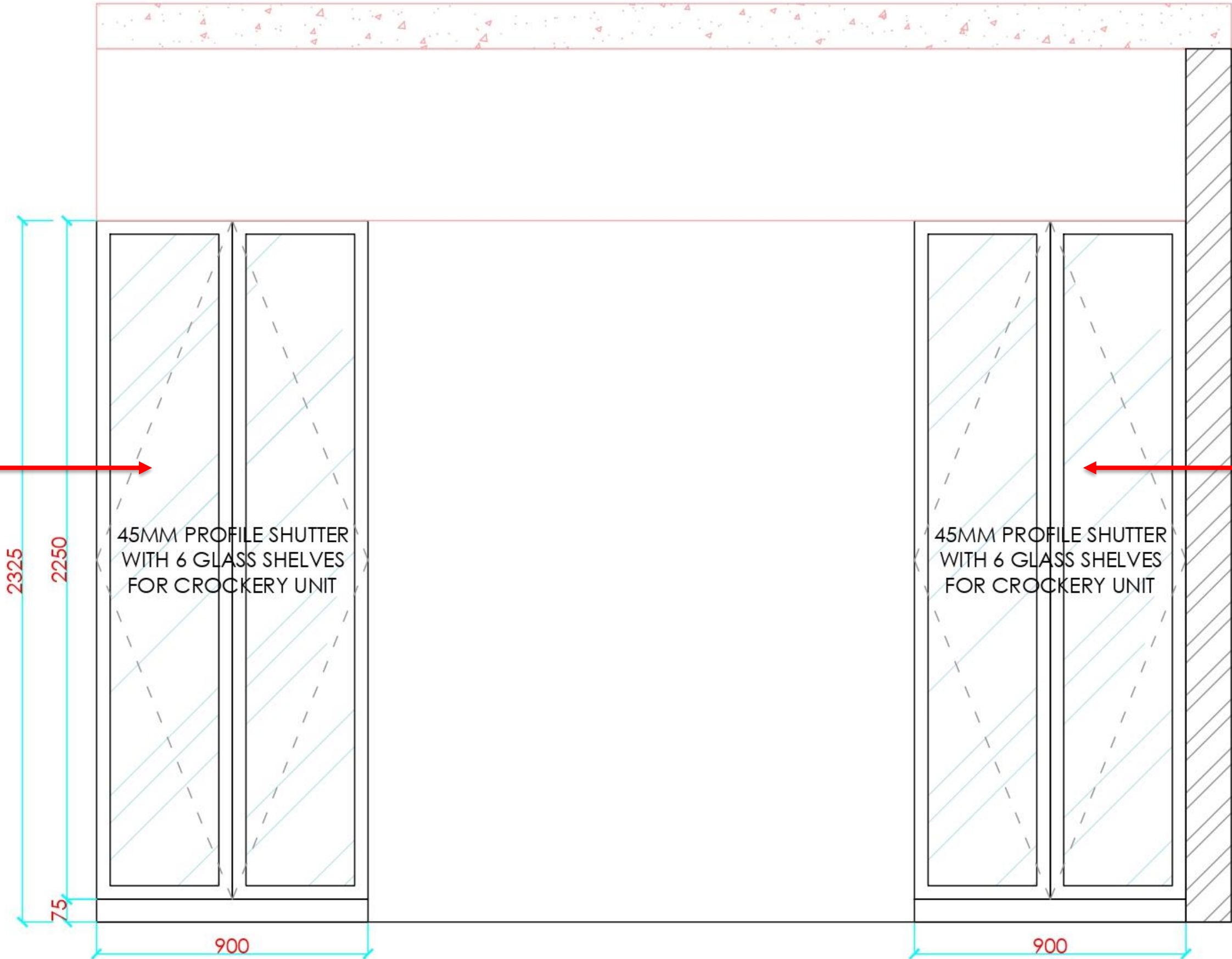

STORAGE FOR BOTTLES AND STEEL DABBAS





# PROPOSED HARDWARE

PLEASE NOTE : IMAGES SHOWN ARE FOR REPRESENTATION PURPOSE ONLY



*BLUM : ANTARO TANDEM  
DRAWERS*



*BLUM : ANTARO TANDEM  
DRAWERS*



*WET & DRY  
DUSTBIN – 2NOS*



*900MM PVC CUTLERY  
TRAY – 1NOS*



*DETERGENT PULL  
-OUT - 1 NOS*



# AWARDS AND RECOGNITION



ACETECH 2019-MUMBAI  
GRANDSTAND AWARD -  
PLATINUM



ECONOMIC TIMES  
PROMISING BRANDS 2019-  
2020



SILICONINDIA  
BRAND OF THE YEAR 2019.





# Connect with us



KITCHENSTUDIO INDIA



KITCHENSTUDIO INDIA



KITCHENSTUDIO INDIA



HOTLINE WHATSAPP  
NUMBER: 8883625625



INFO@KITCHENSTUDIO.IN  
KITCHENSTUDIOMUMBAI@GMAIL.COM

## Andheri (W)

8, Remi Commercio, Shaha Industrial Estate, Opposite Yash Raj Studio, Off New Link road, Andheri West, Mumbai-400053.

## Chembur (E)

Shop No. 8, Ground floor, XLNC Chambers, Opposite Celebrations Hotel, Sion Trombay Road, Chembur East, Mumbai 400071.

## Mulund (W)

KAAIROS by KITCHEN STUDIO, Shop No, 4, Ramchandra Patil Lane, Opp. Runwal Green, Link road, Mulund West, Mumbai 400080.

